

Product being installed: Beacon Surface Mount
Common Customer Assembly IL05021



Series 100



Series 200



Series 300

All Beacon lights:

- Series 100, 200, 300
- 12 and 24 VDC
- Amber, Green, Red, Blue, White color

Parts provided:

- Beacon light
- O-ring
- Mounting hardware
- Optional wiring harness

Mounting Hardware:

- 3-M5 x 30mm Pan Head Screw
- 3-M5 Flat washer
- 3-M5 Hex nut

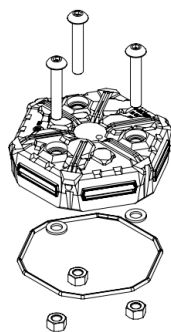

Without wiring harness

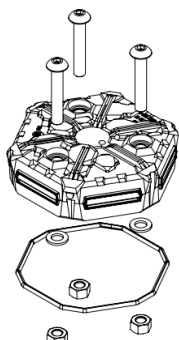

With wiring harness



Safety Message to Installers and Service Personnel

It is important to read and follow all instructions shipped with this product. In addition, listed below are some other important safety instructions and precautions you should follow:

- To be an effective warning device, this product produces bright light that can be hazardous to your eyesight when viewed at a close range. Do not stare directly into this lighting product at a close range or permanent damage to your eyesight may occur.
- Do not install the beacon in an area that would block, impair or blind the driver's vision. Ensure that the beacon is mounted in a position that is outside of the driver's field of vision, so the driver can safely operate the vehicle.
- Never attempt to install aftermarket equipment that connects to the vehicle wiring without reviewing a vehicle wiring diagram available from the vehicle manufacturer. Ensure that your installation will not affect vehicle operation or mandated safety functions or circuits. Always check the vehicle for proper operation after installation.
- Proper placement and installation are vital to the performance of this warning device. Install this product so that output performance of the system is maximized, and the controls are placed within convenient reach of the operator so that he/she can operate the system without losing eye contact with the roadway.

WARNING: LIGHT HAZARD: This product contains high intensity LED's. To prevent permanent eye damage DO NOT look directly into the light beam at close range.

Mounting the Beacon to a Vehicle:

1. Select the desired location on a flat surface for the Beacon to be mounted (Fig 1). The visibility of the flash and ease of wiring access should be taken into consideration in the selection of the mounting location.
2. The Beacon should be mounted only in an upright position as shown in Figure 2.

Figure 1

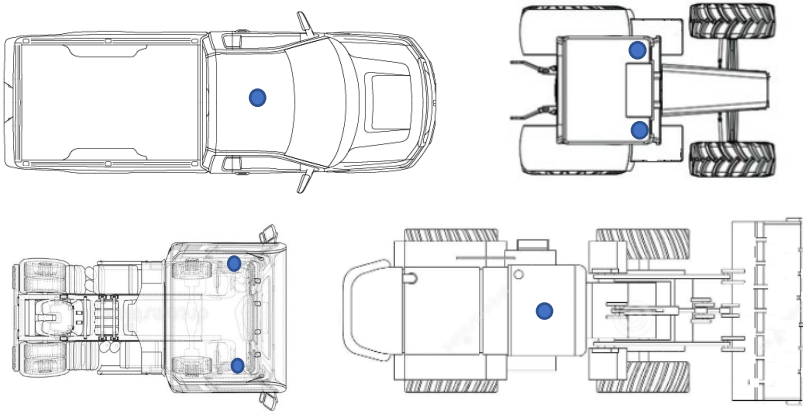

Figure 2



NOTE: Related product information can be found at www.innotecgroup.com/LED-Beacon-Light

3. Using the Beacon, or the mounting hole template shown in Figure 3, mark 3 mounting hole locations.

CAUTION: When drilling into any vehicle surface, make sure that the area is free from any electrical wires, fuel lines, upholstery, etc. that could be damaged.

4. Drill 3 mounting holes. Use the drill bit size shown in Figure 3.
5. Drill center hole for connector body clearance and wire access. Use the drill bit size shown in Figure 3.
6. Install the O-ring onto the Beacon (Fig 4). Use the wire harness provided and connect the power wires as shown in Figure 5 to the vehicle's electrical system. Red wire to positive, Green wire to Negative.
7. Complete the installation by installing and tightening the fasteners to 1.8 N-m (15 in-lbs) +/- 10%.
8. Inspect the Beacon to ensure it is securely fastened to the vehicle.
9. Test the Beacon by applying power and verifying it starts flashing.

Figure 3

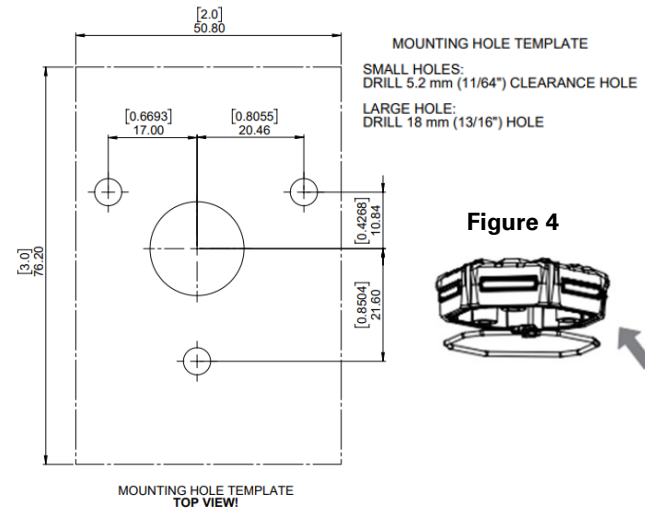

Figure 5

