

Product being installed: Beacon Pole Mount  
Common Customer Assembly **IL05052**



**All Beacon lights:**

- Series 100, 200, 300
- 12 and 24 VDC
- Amber, Green, Red, Blue, White color

**Parts provided:**

- Beacon light
- Pole Mount Assembly
- WPJ wire harness (optional)
- 3-5 x 30mm, Torx head, self tapping screws



**Safety Message to Installers and Service Personnel**

It is important to read and follow all instructions shipped with this product. In addition, listed below are some other important safety instructions and precautions you should follow:

- To be an effective warning device, this product produces bright light that can be hazardous to your eyesight when viewed at a close range. Do not stare directly into this lighting product at a close range or permanent damage to your eyesight may occur.
- Do not install the beacon in an area that would block, impair or blind the driver's vision. Ensure that the beacon is mounted in a position that is outside of the driver's field of vision, so the driver can safely operate the vehicle.
- Never attempt to install aftermarket equipment that connects to the vehicle wiring without reviewing a vehicle wiring diagram available from the vehicle manufacturer. Ensure that your installation will not affect vehicle operation or mandated safety functions or circuits. Always check the vehicle for proper operation after installation.
- Proper placement and installation are vital to the performance of this warning device. Install this product so that output performance of the system is maximized, and the controls are placed within convenient reach of the operator so that he/she can operate the system without losing eye contact with the roadway.

**WARNING: LIGHT HAZARD:** This product contains high intensity LED's. To prevent permanent eye damage DO NOT look directly into the light beam at close range.

## Mounting the Beacon to a Vehicle:

1. Select the desired location on the vehicle (Fig 1) for a pole mount. The visibility of the flash and access to wiring should be considered in the selection of the mounting location.
2. Using an existing Pole and Wiring Harness (Fig 2):
  - a. Inspect the existing pole and wiring harness and verify it is in good working order. There should not be any corrosion, debris or obstructions that could prevent a proper fit or electrical connection. Cleaning or replacing the pole or wiring harness may be necessary if its not in good working order.
  - b. The wiring harness should have a WPJ, 2-pin, waterproof plug to properly connect to the Beacon. Insert the harness through the Pole Mount Assembly.
  - c. Attach the Pole Mount Assembly onto the pole. Make sure to seat the assembly onto the pole approximately 1" (Fig 3). Remove the clip (Fig 4). When properly attached the assembly should fit tight to the pole and not rotate.
  - d. Connect the WPJ plug to the Beacon. Push the plug in until it snaps in place.
  - e. Attach the Beacon to the Polemount Assembly using 3-5 x 30mm, Torx head, self tapping screws provided (Fig 3). Tighten to 1.33 ft-lb (1.8 N-m) +/- 10%. Assembly is complete.
  - f. Apply power to the Beacon and verify it operates properly.

Figure 1

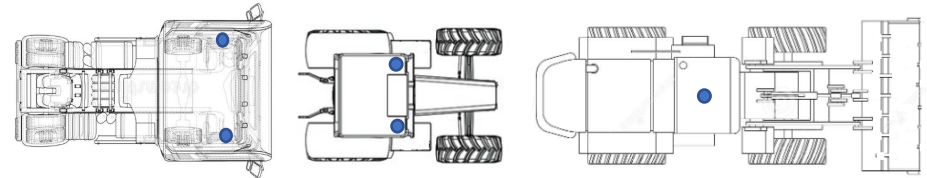

Figure 2

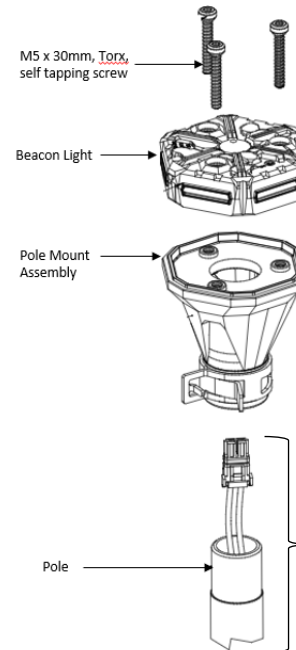

Figure 3

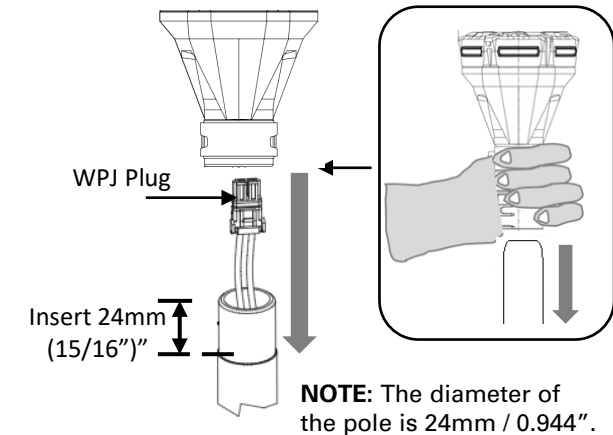
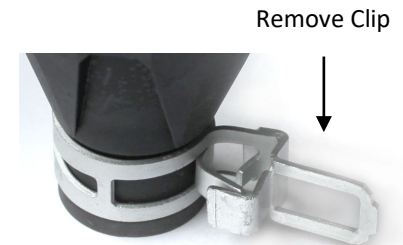

Figure 4



**NOTE:** Related product information can be found at [www.innotecgroup.com/LED-Beacon-Light](http://www.innotecgroup.com/LED-Beacon-Light)

## Mounting the Beacon to a Vehicle:

3. Using the optional WPJ Wiring Harness (Fig 5):
  - a. Inspect the existing pole and verify it is in good working order. There should not be any corrosion, debris or obstructions that could prevent a proper fit or electrical connection. Cleaning or replacing the pole may be necessary if its not in good working order.
  - b. Attach the Pole Mount Assembly onto the pole. Make sure to seat the assembly onto the pole approximately 1" (Fig 6). Remove the spring clip (Fig 7). When properly attached the assembly should fit tight to the pole and not rotate.
  - c. Connect the power wires as shown in Figure 5 to the vehicle's electrical system. Red wire to positive, Green wire to Negative.
  - d. Connect the WPJ plug to the Beacon. Push the plug in until it snaps in place.
  - e. Attach the Beacon to the Polemount Assembly using 3-5 x 30mm, Torx head, self tapping screws provided.
  - f. Apply power to the Beacon and verify it operates properly.

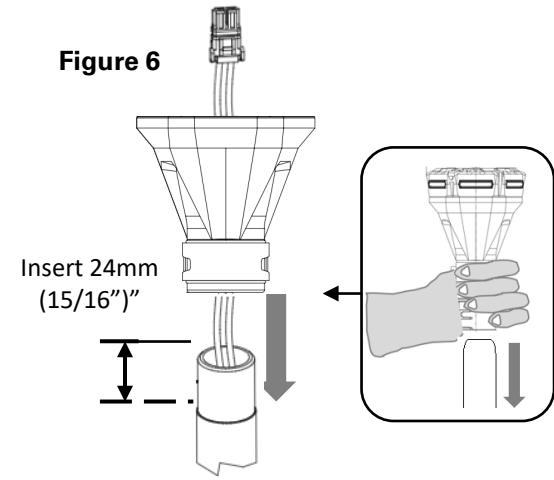
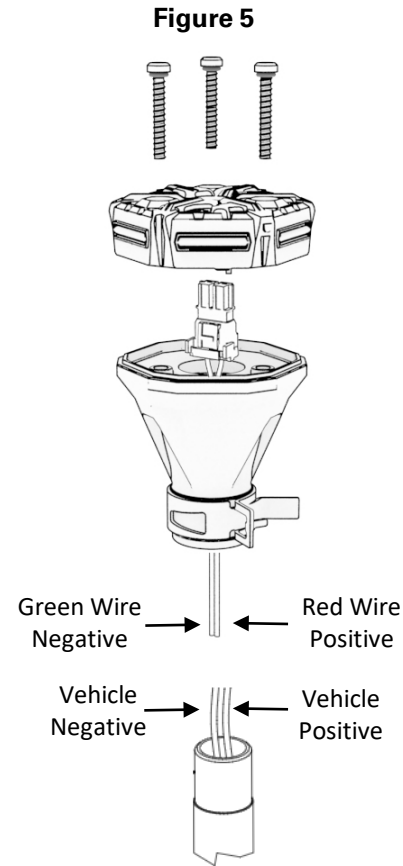

**NOTE:** The diameter of the pole is 24mm / 0.944".

**Figure 7**

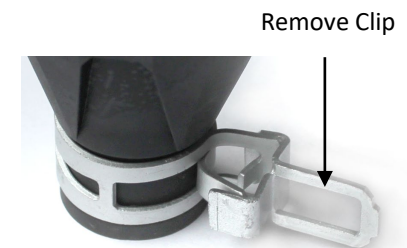

**WARNING: LIGHT HAZARD:** This product contains high intensity LED's. To prevent permanent eye damage DO NOT look directly into the light beam at close range.